

# ZERO<sub>2</sub> DRYOXO™

## Oxygen and Moisture Removal System

Our reliable, patented Oxygen removal technology can be paired with a TSA to create an environmentally safe solution for eliminating both oxygen and moisture from biogas streams, including dairy, swine as well as Landfill Gas (LFG) operations.

- Remove oxygen and moisture to meet the most stringent pipeline specifications
- Generate incremental revenue by upgrading biogas or LFG to valuable RNG
- As few moving parts as possible for high reliability
- Intuitive, practical design to facilitate ease of maintenance over competing solutions
- Easy and quick to scale up, or down, as your biogas volumes change

### ZerO<sub>2</sub> DryOxo Specifications

Operating Pressure: . . . . . 75 - 150 psig (max)  
 Design Pressure: . . . . . 167 psig  
 Turndown: . . . . . 2:1  
 Typical Pressure Drop: . . . . . 10-15 psi  
 Max O<sub>2</sub> at Inlet: . . . . . 15,000-17,500 ppm  
 H<sub>2</sub>O at the inlet. . . . . no free liquids  
 Typical O<sub>2</sub> at Outlet: . . . . . 0-10 ppm, < 5 ppm optional  
 Typical H<sub>2</sub>O at outlet: . . . . . 7 lbs/MMSCF  
 Max H<sub>2</sub>S at Inlet: . . . . . 2 ppm  
 Skid Hazard Classification: C1D2 (excl. 480 VAC Power Panel)  
 480 VAC Power Panel: . . . . . remote-mounted, not rated for hazloc  
 Cooling water temp: . . . . . 35-50 F  
 Drying Media: . . . . . Molecular Sieve

Model	Flow Capacity	Connection Size and Type	Approx. Weight	Dimensions	Power Requirements	FLA
DryOxo E300	210 SCFM / 337Nm <sup>3</sup> /Hr	2" 300# RF	10,000 lbs	13ft x 8ft x 11.5ft	480 VAC / 3 Phase   60 Hz	115
DryOxo E750	520 SCFM / 835Nm <sup>3</sup> /Hr		13,000 lbs			134
DryOxo E1200	830 SCFM / 1332Nm <sup>3</sup> /Hr	3" 300# RF	17,000 lbs	20ft x 8ft x 11.5ft		252
DryOxo E2000	1390 SCFM / 2231Nm <sup>3</sup> /Hr		20,500 lbs			270



### Skid Features Include:

- All vessels manufactured and stamped per ASME Section VIII, Div. 1, NB registered
- 100% Domestic Structural Steel
- Fully automatic, 100% closed loop regeneration cycle
- Insulated adsorber vessels and electric heater vessel for best thermal performance
- Coalescing pre-filter and particulate after-filter complete with differential pressure indicators
- Remote Monitoring included
- Discharge water content options for sub 7 lb/MMSCF down to < 5 ppmv

## ZerO<sub>2</sub> DryOxo Typical Pressure Drop as a Function of Flow Rate

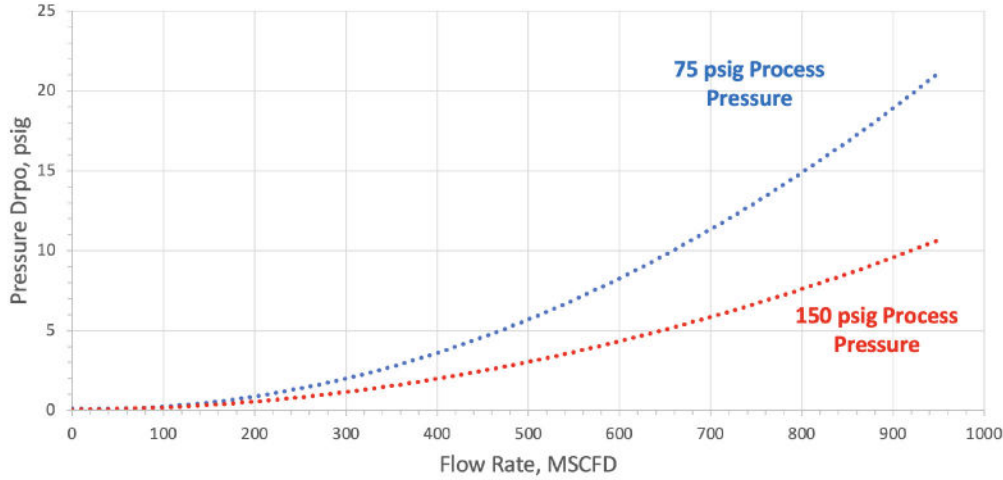

### Corporate Office

1422 Delgany St. Suite 100  
Denver, CO 80202

### Field Offices

1804 Cherry Ave.  
Greeley, CO 80631

915 Goode St.  
Midland, TX 79701

5072 Owan Industrial Park Dr.  
Williston, ND 58801

## ZerO<sub>2</sub> DryOxo

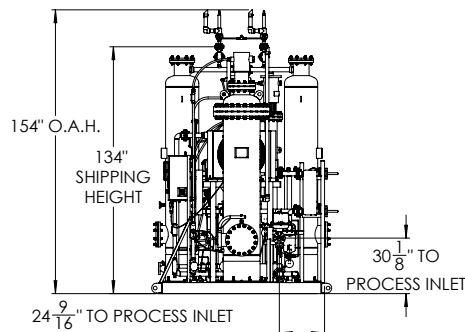
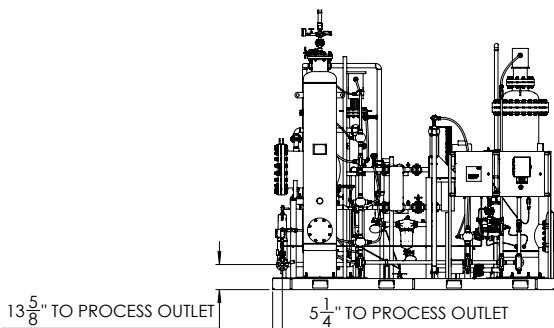
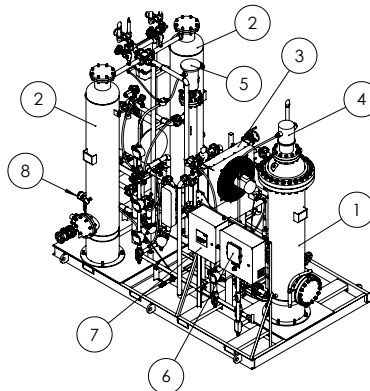
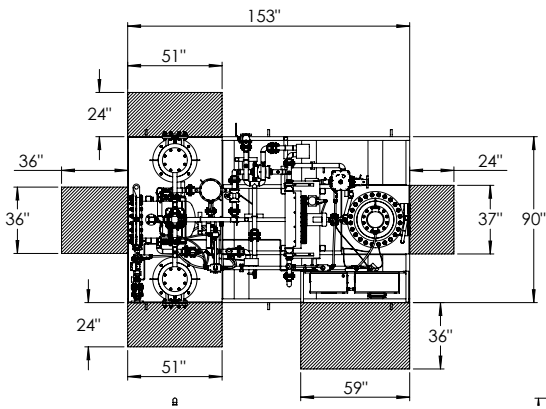

info@EcoVaporRS.com

1-844-No-Flare  
(844.663.5273)